

TPC190-A19

Aluminum alloy panel structure, IP65 waterproof front panel, the whole machine has low power consumption, 2.5mm short step narrow edge panel design, designed for cabinet equipment supporting the creation of seamless embedded installation, the panel is flush in the cabinet, harmonious and neat, highlighting the beauty of science and technology.

Features

- Narrow bezel design built for flush mount applications
- High-precision aluminum alloy die-casting, IP65 waterproof and dustproof front panel
- Self-developed ARM architecture industrial motherboard
- RK3588, Eight core 64 bit core architecture, 4*Cortex-A76+ 4*Cortex-A55
- Built-in independent NPU with 6 TOPS AI computing power

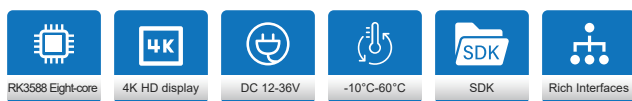

Product Model

Product Size	19"
Non-touch	TPC190-A1900
Capacitive touch	TPC190-A1910
Resistive touch	TPC190-A1920

Product Interface



Product Specifications

Screen Parameters

LCD size	19" TFT LCD		
Resolution	1280*1024 (Aspect Ratio 5:4)		
Viewing angle	85/85/80/80 (L/R/U/D)		
Colour	16.7M		
Brightness	300 cd/m ²		
Contrast ratio	1000:1		

Touch Parameters

Touch type	10-point touch projection Capacitive touch screen	Single-point Resistance touch screen	Non-touch
Transmittance	≥88%	≥78%	≥92%
Input mode	Handwriting or Capacitance pen	Fingertip or stylus	/
Controller communication	USB	USB	/

Hardware Configuration

CPU	RK3588, Eight core 64 bit core architecture, 4*Cortex-A76+4*Cortex-A55	NPU	Built-in NPU with 6 TOPS AI computing power
Memory	8G LPDDR4 (Optional 4G/16G/32G, It supports up to 32G)	WiFi	WiFi 6 Single Band, 2.4G
Storage	64G eMMC (It supports up to 256G)	Bluetooth	Support Bluetooth 5.0
GPU	ARM Mali-G610 MP4	Operating system	Android 13.0, Linux, Ubuntu, Debian

Product Size

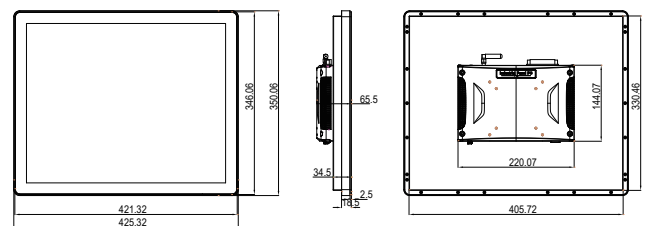

Physical Characteristics

Overall dimensions	W425.32x H350.06x D65.5mm
--------------------	---------------------------

Interface Parameters

Industrial terminals	1*12P Phoenix terminal (Power supply/RS232*1/RS485*1/CAN*1/GPIO*3)
Power interface	1*DC2.1, Supporting 12V-36V power input
USB	1*USB3.0, 1*USB2.0
TF	1*TF card standard interface
HDMI	1*HDMI, Supporting HDMI data output, Up to 4K
SIM	1*SIM, Supporting various formats (Depending on 3G/4G module)
Network interface	1*LAN, 10M/100M/1000M adaptive Ethernet
Audio interface	1*Audio I/O, Support audio input and output
COM	1*RS232
Reset key	Support (1*UBOOT)
WiFi antenna	1*WiFi antenna
Grounding post	1*Grounding post (GND)

Product Reliability Parameters

Working temperature	-10°C~60°C
Storage temperature	-20°C~70°C
Relative humidity	Humidity: 95% Non-Condensing
Vibration protection	IEC 60068-2-64, Random, 5~500 Hz, 1 hr/axis
Impact protection	IEC 60068-2-27, Half sine wave, Lasting for 11ms
Product certification	CCC/CE/FCC/EMC/CB/ROHS
Waterproof grade	The front panel reaches IP65 protection level

Power Parameters

Power input	DC 12V-36V
Static power	18W